



## AMACO® Fused Glass Jewelry Technique Sheet #25

To get started with a fused glass jewelry project, read the list of materials found in AMACO® Jewelry Kit 40079A found below:

**Materials included in AMACO® Jewelry Kit:**  
C.O.E. 90 Glass: Two 6" x 6" glass sheets, (1) clear and (1) white; and (1) 3" x 3" glass sheet in each of the following 7 colors (cobalt, tangerine, Kelly green, grenadine, black granite, lime, aqua); (1) 5 oz. tube containing glass stringers/noodles in assorted colors; and (1) 2 oz. jar of glass chunks in assorted colors. One metal glass cutter, 4 oz. jar of cutting fluid, running glass pliers, and 1-pound jar of AMACO® kiln wash.

Remember: Safety Goggles should always be worn when cutting and breaking glass.

### Step 1. Cut Glass

Cut glass at a cutting station that has a fiberboard mat or felted surface, such as a blanket. First, dip Metal Glass Cutter in Cutting Oil; then score by pressing firmly (on the smooth side of the glass) along a predetermined line with the Glass Cutter.



### Step 2. Break Glass

Use the Glass Pliers to break the glass apart by lining the arrow on the pliers with the score, then applying pressure to the grip.



### Step 3. Create a Design

Create a design by choosing a base piece of glass and arranging glass shapes, stringers, noodles and chunks. Stack glass no higher than 4 layers for uniform results. Stabilize the glass by using school glue between layers. Glue will burn off in the kiln.

For additional effects, layer AMACO® WireMesh®, WireForm® or ArtEmboss® in Copper color only between glass sheets. (Sold separately).

### Step 3. Make a Jewelry Finding

With the wire provided, create a loop. Cut the wire using wire snips. Make sure the finding is a full circle shape and not a "U" shape; so that the wire will not slip out once glass is fired. Sandwich the wire loop between two pieces of glass. Leave a small area exposed; so that attachments can be made after firing.

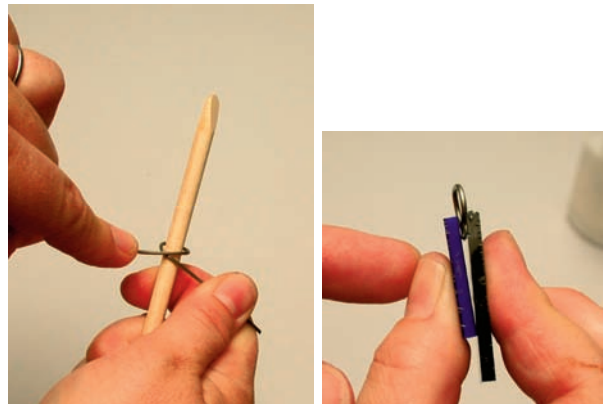

Instructions continued on back

#### Step 4. Prepare Kiln Shelf

Carefully mix AMACO® Kiln Shelf Wash in a container. Do not create dust. Add water gradually, stirring slowly until a light creamy consistency is achieved. Apply three even coats of wash to kiln shelf. Allow each coat to dry. Place glass pieces in a single layer (with at least 1/8" between). Program the kiln for glass fuse firing.



#### Step 5. Finish the Piece

Once the kiln has cooled to room temperature, the glass is ready to be removed. In most cases, glass will be ready to use. However, finished pieces may have rough edges or kiln wash on back. Smooth rough edges with fine sandpaper and remove kiln wash with soapy water.



#### The Importance of C.O.E. Glass

*Included in AMACO® Fused Glass Jewelry Kit*

Glass pieces used in same firings must have the same C.O.E. rating. C.O.E. stands for coefficient of thermal expansion and relates to how the glass expands and contracts due to temperature changes. Different glass has different C.O.E. numbers. If the glass used for fusing does not have the same C.O.E. number, it will crack and break. To be guaranteed compatible C.O.E. glass, buy glass from the same source and check the label to be sure that the C.O.E. is the same.

*All AMACO® glass has a C.O.E. of 90 and is guaranteed to be compatible.*

#### Ceramic Kilns vs. Glass Kilns

Although not optimal, a ceramic kiln will fire glass adequately for most school projects. Glass requires a more precise firing process than ceramics; AMACO® recommends that only Select Fire™ or computerized kilns be used to fire glass. For easy to follow step-by-step computer programming, visit [www.amaco.com](http://www.amaco.com) and download the Glass Kiln Manual.



*Shown with bead door open, main door closed.*

#### AMACO® GSF-045 Warm Glass Kiln

For studio or school use for fusing, tacking, slumping or jewelry glass projects. UL Listed, with Glass Select Fire™ controller for accurate and stable firing temperatures for small projects. *GSF-045, Item No.24142T, 115V Household Current.*

#### Follow Safety Precautions

All AMACO® lesson plans state that adults and teachers supply adequate supervision for children and students, as many art curriculums are expanding to include glass. Always use safety goggles. Safe firing instructions can be found at [amaco.com](http://amaco.com) or by calling AMACO® Customer Service Monday through Friday, from 8 to 5 EST.



*Child Size Safety Goggles, Item No. 40074T*

*Project ideas, lesson plans, products and glass information are all available at [amaco.com](http://amaco.com). For technical and product information, e-mail [talktous@amaco.com](mailto:talktous@amaco.com) or call 800-374-1600.*

*American Art Clay Co., Inc.  
6060 Guion Road, Indianapolis, IN 46254 **11583A***